

1616-VO Universal Vanity Sink

(overflow model)

I.D.: 15 3/4" diameter (400 mm)

Depth: 5" * (127 mm)

*Depth does not include counter top thickness



The Gemstone 14 3/4" Diameter Round Universal Design lavatory bowl is part of Gemstone's commitment to design that is appealing to all. Designed with healthcare providers in mind, design, function, and performance are critical providing today's architects, and

installers the ease of installation while conforming to today's ADA standards. The 1616-VO is ideal for all applications, residential, clinical, commercial, restaurants and laboratories. The depth of the bowl allows for easy ADA applications. The 1616-VO has a smooth overflow tube which minimizes infection control in hospital applications.

Gemstone Sinks are compatible and warranted when used with all major solid surface sheet brands (acrylic and polyester) with the same sheet warranties.

 Gemstone supports conservation and green building practices. Gemstone Packages all products in 100% recyclable packaging using boxes made primarily of recycled paper.



Gemstone sinks are proudly made in the USA and certified by:

Home Innovation Lab (NAHB) : HUD UM Bulletin No. 73a & (B45.5/IAPMO Z124 Z124.6)

UL in the US and Canada: HUD UM Bulletin No. 73a & (B45.5/IAPMO Z124 Z124.6)



For router bit recommendations visit:
www.Gemstoness.com/Tech

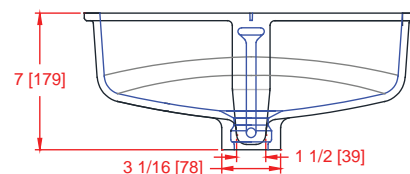
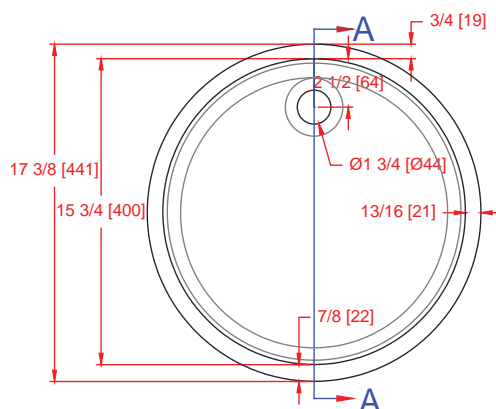

Front View

