

1217-V Lavatory Bowl

(No overflow model)

I.D.: 17 7/8" x 11 15/16" (454 mm x 303 mm)

Depth: 5 11/16" * (145 mm)

*Depth does not include counter top thickness



The Gemstone 1217-V is one of the newest additions to the Gemstone vanity line-up. The rear integrated overflow uses a non corrugated tube minimizing trapped bacteria as well lends to an easy ADA installation when needed with a deeper than normal ADA bowl.

The 1217 is available in both overflow and non overflow models and works well in commercial and residential applications.

Gemstone Sinks are compatible and warranted when used with all major solid surface sheet brands (acrylic and polyester) with the same sheet warranties.



Gemstone supports conservation and green building practices. Gemstone Packages all products in 100% recyclable packaging using boxes made primarily of recycled paper.



Gemstone sinks are proudly made in the USA and certified by:

Home Innovation Lab (NAHB) : HUD UM Bulletin No. 73a & (B45.5/IAPMO Z124 Z124.6)

UL in the US and Canada: HUD UM Bulletin No. 73a & (B45.5/IAPMO Z124 Z124.6)



For router bit recommendations visit:
www.Gemstoness.com/Tech

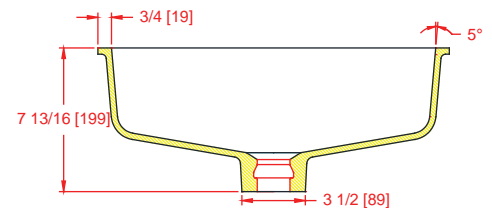
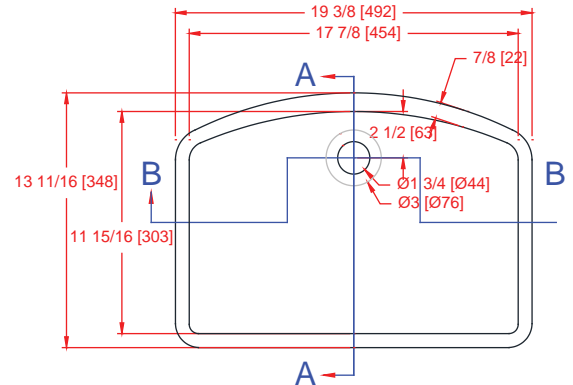

Section B-B

